

LED UMBRELLA 95/140

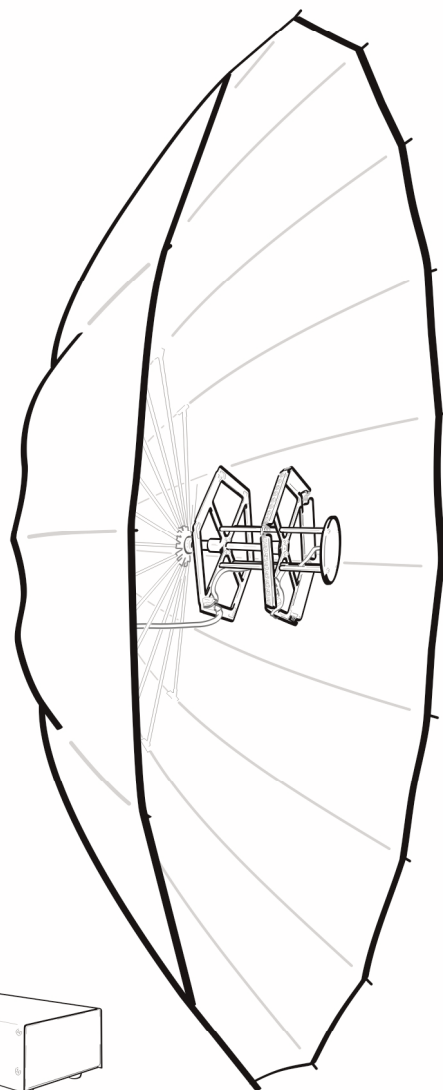

User manual



STAND
ALONE

MASTER
SLAVE

STROBE

DMX

FLICKER FREE

RGB

USER MANUAL

LED Umbrella 95/140

**DANGER! Electric shock caused by short-circuit**

Be careful with your operations. With a dangerous voltage you can suffer a dangerous electric shock when touching the wires. Never open the housing. Keep the device away from rain and moisture.



Please read these instructions carefully before using the product. They contain important information for the correct use of the product.

Every person involved with the installation, operation and maintenance of this device has to

- be qualified
- follow the instructions of this manual
- consider this manual to be part of the total product
- keep this manual for the entire service life of the product
- pass this manual on to every further owner or user of the product
- download the latest version of the user manual from the Internet

INTRODUCTION

Thank you for having chosen one of our products. If you follow the instructions given in this manual, we are sure that you will enjoy this device for a long period of time.

Product features

Extraordinary RGB eye-catcher

- DMX-controllable lighting effect umbrella with 114 SMD RGB LEDs, distributed in 7 segments
- Segments can be controlled individually via DMX
- 6 segments make the surface of the umbrella shine, one segment in the middle shines directly at the audience
- Flicker-free projection
- Perfect as stage background and eye-catcher for decorative purposes in shops, display windows, fair stands, hotels, bars and clubs
- Can be mounted to a lighting stand or trussing - the umbrella's angle can be adjusted
- Easy transport (can be folded), setup and installation
- Covers an area with a diameter of 95 cm (item 42111010) or 140 cm (item 42111000)
- Auto, music, master/slave and DMX mode
- Built-in auto and music show programs
- 6 or 24 DMX channels selectable
- Stepless RGB color mixture, dimmer and strobe effect
- Sound-control via built-in microphone
- Supports QuickDMX
- Built-in phantom-powered USB port for QuickDMX receivers (accessories)
- DMX512 control possible via any commercial DMX controller
- Addressing via control panel with 4-digit LED display
- Appropriate control unit included in the delivery
- Power connection via P-Con jack and included power cable with safety plug

SAFETY INSTRUCTIONS

**WARNING!**

Please read the safety warnings carefully and only use the product as describe in this manual to avoid accidental injury or damage.

Intended use

- This device is a LED lighting effect for creating decorative effects. This device is designed for professional use in the field of event technology, e.g. on stage. It is not suitable for household lighting.
- Only use the device according to the instructions given herein. Damages due to failure to follow these operating instructions will void the warranty! We do not assume any liability for any resulting damage.
- We do not assume any liability for material and personal damage caused by improper use or non-compliance with the safety instructions. In such cases, the warranty/guarantee will be null and void.
- Unauthorized rebuilds or modifications of the device are not permitted for reasons of safety and render the warranty invalid.

Danger due to electricity

- The device is suitable for indoor use only. Do not use it outdoors. Never expose it to rain or moisture. Do not store it in rooms exposed to moisture.
- To reduce the risk of electric shock, do not open any part of the device. There are no serviceable parts inside the device.
- Only connect the device to a properly installed mains outlet. The outlet must be protected by residual current breaker (RCD). The voltage and frequency must exactly be the same as stated on the device. If the mains cable is equipped with an earthing contact, then it must be connected to an outlet with a protective ground. Never defeat the protective ground of a mains cable. Failure to do so could result in damage to the device and possibly injure the user.
- The mains outlet must be easily accessible so that you can unplug the device quickly if need be.
- Never touch the mains plug with wet or damp hands. There is the risk of potentially fatal electric shock.
- The mains cable must not be bent or squeezed. Keep it away from hot surfaces or sharp edges.
- Never pull the mains cable to disconnect the mains plug from the mains outlet, always seize the plug.
- Unplug the device during lighting storms, when unused for long periods of time or before cleaning.
- Do not expose the device to any high temperatures, direct sunlight, dripping or splashing water, strong vibrations or heavy mechanical stress.
- Do not place any objects filled with liquids on the device.
- Do not place any open sources of fire, such as burning candles, on or directly next to the device.
- Make sure that objects cannot fall into the device, in particular metal parts.
- Only have repairs to the device or its mains cable carried out by qualified service personnel. Repairs are required when the device or the mains cable is visibly damaged, liquid has been spilled or objects have fallen into the device; when the device has been exposed to rain or moisture, has been dropped or malfunctions occur.
- Cleaning of the device is limited to the surface. Make sure that moisture does not come into contact with any areas of the terminal connections or mains voltage control parts. Only wipe off the product with a soft lint-free and moistened cloth. Never use solvents or aggressive detergents.

Danger to children and people with restricted abilities

- This product is not a toy. Keep it out of the reach of children and pets. Do not leave packaging material lying around carelessly. Never leave this device running unattended.
- This device may be used only by persons with sufficient physical, sensorial, and intellectual abilities and having corresponding knowledge and experience. Other persons may use this device only if they are supervised or instructed by a person who is responsible for their safety.

Warning – risk of burns and fire

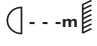
- The admissible ambient temperature range (T_a) is -5 to $+45^{\circ}\text{C}$. Do not operate the device outside of this temperature range.
- The housing temperature (T_c) can be up to 50°C during use. Avoid contact by persons and materials.
- Do not illuminate surfaces within 10 cm of the device. This value is indicated on the device by the  symbol.
- Do not use the device near highly flammable materials. Always place the device at a location where sufficient air circulation is ensured. Leave 50 cm of free space around the device. Never cover the air vents of the housing.
- Only operate the device in moderate climate, never in tropical climate.

Warning – risk of injuries

- Do not look directly at the light source. Persons with light-sensitive epilepsy may suffer from epileptic seizures or fall unconscious.
- Make sure that the product is set up or installed safely and expertly and prevented from falling down. Comply with the standards and rules that apply in your country, in particular EN 60598-2-17.
- If you lack the qualification, do not attempt the installation yourself, but instead use a professional installer. Improper installation can result in bodily injury and or damage to property.
- The manufacturer cannot be made liable for damages caused by incorrect installations or insufficient safety precautions.
- For overhead use, always secure the device with a secondary safety attachment such as a safety bond or safety net.
- Make sure that the area below the installation place is blocked when rigging, derigging or servicing the device.
- For commercial use the country-specific accident prevention regulations of the government safety organization for electrical facilities must be complied with at all times.

Caution – material damage

- This device must not be connected to the mains voltage by means of a dimmer.
- Lighting effects are not designed for permanent operation. Consistent operation breaks will ensure that the device will serve you for a long time without defects.
- Never switch the device on and off at short intervals. This will considerably reduce the service life of the device.
- If the device has been exposed to drastic temperature fluctuation, do not switch it on immediately. The resulting condensation may destroy the device. Allow the device to reach room temperature before connecting it. Wait until the condensation has evaporated.
- Please use the original packaging to protect the device against vibration, dust and moisture during transportation or storage.
- If a serial number label is affixed to the device, do not remove the label as this would make the guarantee void.
- The LED module must only be operated with the enclosed control unit.

DANGER OF BURNING!

The materials used in this device are easily flammable. If B1 is required at the installation place, this product must not be used or safety precautions must be applied!

DESCRIPTION OF THE DEVICE

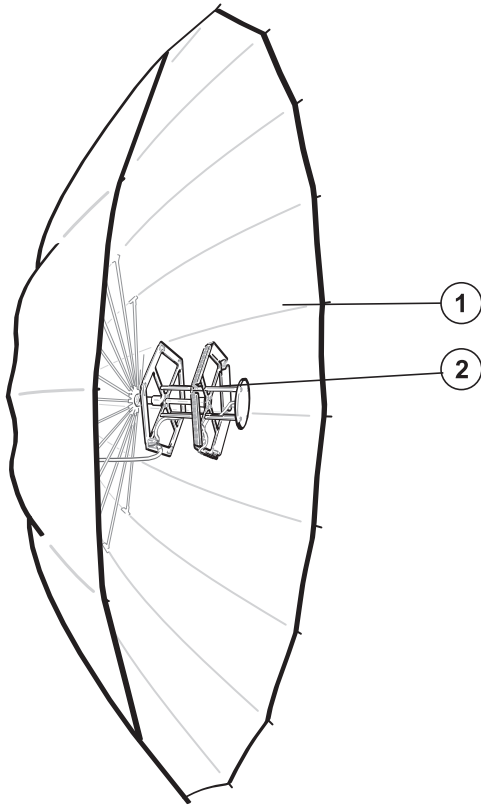

- (1) Umbrella
- (2) LED module

- (3) Control unit/interface
- (4) USB port for QuickDMX receiver
- (5) Menu-button
- (6) Up-button
- (7) Down-button
- (8) Enter-button
- (9) Display

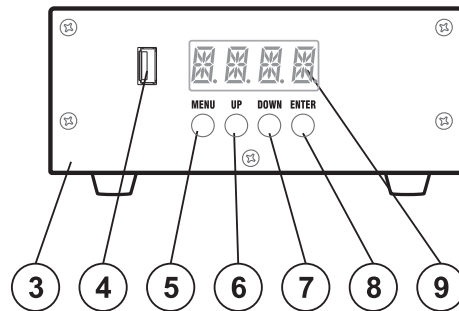

- (10)DMX input
- (11)Rubber foot
- (12)Attachment eyelet
- (13)DMX output
- (14)Omega clamp
- (15)Signal output
- (16)Power input
- (17)Fuse holder

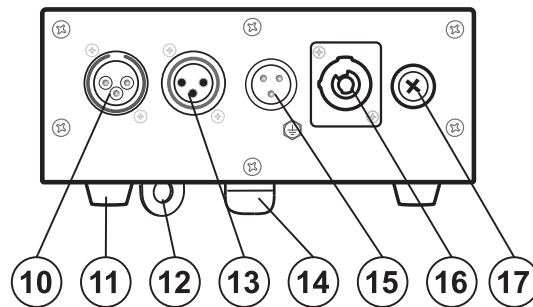

INSTALLATION



WARNING! Risk of injury caused by falling objects

Devices in overhead installations may cause severe injuries when crashing down. Make sure that the device is installed securely and cannot fall down. The installation must be carried out by a specialist who is familiar with the hazards and the relevant regulations.

The device may be placed via the enclosed mounting adapter on a lighting stand or fastened with an appropriate clamp to a truss or similar rigging structure. The device must never be fixed swinging freely in the room.

- 1 The rigging structure must support at least 10 times the weight of all fixtures to be installed on it.
- 2 Block access below the work area and work from a stable platform when installing the device.
- 3 Use rigging hardware that is compatible with the structure and capable of bearing the weight of the device. Please refer to the "Accessories" section for a list of suitable rigging hardware.
- 4 Secure the device with a safety bond or other secondary attachment. This secondary safety attachment must be sufficiently dimensioned in accordance with the latest industrial safety regulations and constructed in a way that no part of the installation can fall down if the main attachment fails.
- 5 After installation, the device requires inspections periodically to prevent the possibility of rot, deformation and looseness.

Installation on a lighting stand

Please note: All devices, lighting effects and crossbeams attached on a stand must be secured with a secondary attachment!

- 1 First, loosen the fixation screws at the stand's levelling feet. Pull out the levelling feet until the cross struts and the levelling feet form a 90° angle. Now retighten the fixation screws.
- 2 Remove the tip of the top of the umbrella and put the top of the umbrella through the umbrella intake of the adapter. Now reattach the tip and tighten the two crosshead screws of the adapter in order to fix the tip in the adapter.
- 3 Attach a crossbeam adapter or TV pin to the upper end of the stand and tighten it with the fixation screw.
- 4 Fix the enclosed mounting adapter to the TV pin and tighten the pin's fixation screw.
- 5 Carefully span the umbrella. Loosen the adapter's fixation screws, set the desired tilt and firmly retighten the screws in order to align the device.
- 6 Remove the extension bar inside the umbrella and put it aside for dismantling the device later. Put the LED module on top of the remaining, shortened bar inside the umbrella. Now firmly tighten the knurled head screws in order to fix the LED module inside the umbrella.
- 7 Caution! The stand requires an even load distribution. The maximum load must never be exceeded. The lighting stand must stand firmly on the ground. Make sure that all fixation screws are firmly tightened.
- 8 The cutout on the umbrella is necessary for the wiring.
- 9 After installation, the device requires inspections periodically to prevent corrosion, deformation and loosening.

Installation on a crossbeam

- 1 Remove the end of the tip of the umbrella and put the tip through the adapter's umbrella intake. Reattach the tip. Tighten the adapter's crosshead screws in order to fix the tip inside the adapter.
- 2 Use a M10 screw and a self-locking nut to screw a hook to the adapter.
- 3 Use the adapter to attach the device to your crossbeam system.
- 4 Insert the quick link of the safety rope into the adapter's attachment eyelet and pull the safety rope over the crossbeam or another safe fixing point. Then insert the end of the rope into the quick link and firmly tighten the fixation screw.
- 5 The control unit may be placed on the floor or fastened to a truss or similar rigging structure. The device must never be fixed swinging freely in the room. Screw a clamp via a M10 screw and self-locking nut onto the omega-holder. Insert the two screws of the enclosed omega-holder into the respective holes on the bottom of the device. Tighten the screws fully. Use a safety rope or another appropriate structure as secondary attachment for the control unit. Fully screw the safety eyelet into the bottom of the control unit. Insert the quick link of the safety rope into the safety eyelet in the bottom and pull the safety rope over the crossbeam or another safe fixing point. Insert the rope's end into the quick link and firmly tighten the fixation screw.
- 6 The device's drop distance must not exceed 20 cm. Fix the safety rope respectively.

CONNECTIONS

DMX512 control

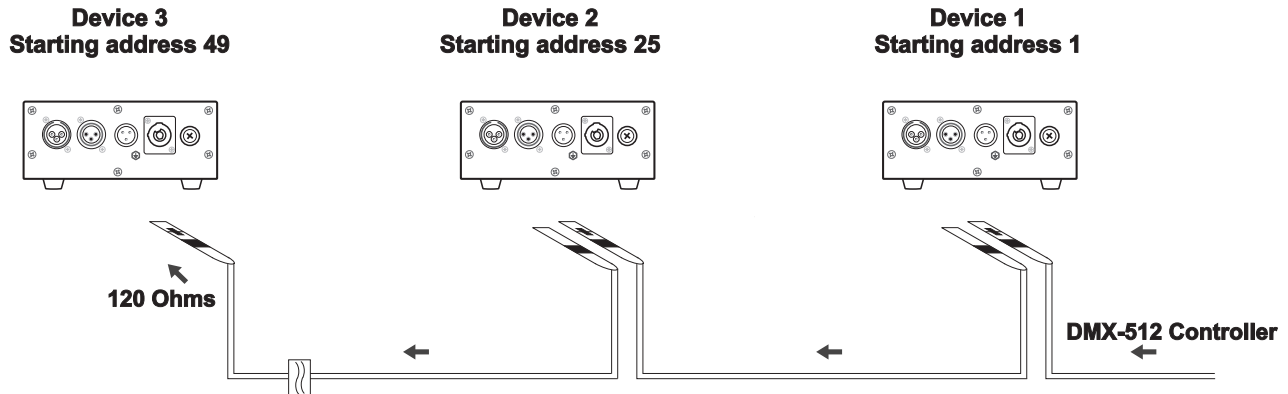

A DMX512 data link is required in order to control the device via DMX. The device provides 3-pin XLR connectors for DMX connection.

- 1 Connect the output of your DMX controller to the DMX input DMX IN of the device with a DMX cable.
- 2 Connect the DMX output DMX OUT of the device to the DMX input of the next unit in the chain. Always connect one output to the input of the next unit until all units are connected.
- 3 At the last unit, the DMX cable has to be terminated. Plug the terminator with a 120 Ω resistor between Signal (-) and Signal (+) in the DMX output of the last unit.
- 4 If the cable length exceeds 300 m or the number of DMX devices is greater than 32, it is recommended to insert a DMX level amplifier to ensure proper data transmission.

XLR connection:



Wireless DMX transmission with QuickDMX

The device features an alternative DMX input for a QuickDMX receiver (sold separately). This connector allows for wireless transmission of DMX control signals to the device. The connector is designed as a USB port which provides the required 5 V operating voltage for the receiver. With QuickDMX devices, extensive cabling between the DMX controller and the device is not required.

Occupation of the USB port:

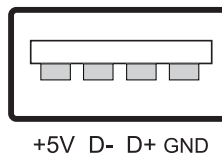

Connection to the mains

The device uses an auto-range power supply that accepts input voltages between 100 und 240 volts.

- 1 Connect the LED module via the enclosed signal cable with the control unit. The LED module is powered by the control unit.
- 2 Connect the device via the mains cable to a grounded mains socket. Thus the unit is switched on.
- 3 To switch off the unit, disconnect the power plug.
- 4 Do not connect the unit to the mains voltage via a dimmer. For a more convenient operation, use a mains outlet which is switchable.

The device is equipped with a lockable power input connector. Plug in the power cord and turn it to the right until it locks. Plug the power cord into a grounded electrical outlet that matches the rated voltage of the machine.

OPERATION

After connecting the device to the mains it is ready for operation. The display indicates the last operating mode. The operating modes can be selected by means of the display and the control buttons. All settings remain stored even if the device is disconnected from the mains. The device can be operated in stand-alone mode via the control board or in DMX-controlled mode via any commercial DMX controller.

Menu structure

The main menu is accessed by pressing Menu until the display is lit. Browse through the menu by pressing Menu. Press Enter in order to select the desired menu. You can change the selection by pressing Up or Down. Press Enter in order to confirm. You can leave every mode by pressing Menu. The functions provided are described in the following sections.

Mode	Display		Function	
Individual color mix / strobe effect	STAT	R.xxx	R.000-255	Red 0-100%
		G.xxx	G.000-255	Green 0-100%
		b.xxx	b.000-255	Blue 0-100%
		ST.xx	ST.00-20	Strobe effect slow to fast
Automatic mode	AUTO	AT.xx	AT.01-52	Program 1 - 52
Running speed in automatic mode		SP.xx	SP.01-20	Program running speed slow to fast
Sound control	SOUD	MOD1		Program 1
		MOD2		Program 2
DMX mode	dMX	d.xxx	d001-512	Starting address
	PERS	6CH.		6-channel mode
		24CH.		24-channel mode

Stand-alone mode

Individual color mix / strobe effect

In the color mode **STAT** each of the tricolor LEDs can be individually adjusted for brightness. The device will constantly emit the color adjusted.

- 1 Press the **MENU** so many times until **STAT** is indicated in the display. Confirm with the **ENTER** button.
- 2 Now the display indicates the letter **R** for the color red and the corresponding brightness value. Use the buttons **UP** and **DOWN** to adjust the desired brightness.
- 3 Confirm with the **ENTER** button. Now the color green can be adjusted; then blue.
- 4 Confirm with the **ENTER** button. The display will show **ST**. Use the buttons **UP** and **DOWN** to adjust the desired strobe speed (**ST.00** = slow, **ST.20** = fast). Confirm with the **ENTER** button.

Automatic mode

In automatic mode, 52 show programs are available that run at an adjustable speed.

- 1 Press the **MENU** button so many times until **AUTO** is indicated in the display. Confirm with the **ENTER** button. Use the buttons **UP** and **DOWN** to select the desired show program (**AT.01** - **AT.52**). Confirm with the **ENTER** button.
- 2 Press the **MENU** button so many times until **SP.xx** is indicated in the display. Confirm with the **ENTER** button. Use the buttons **UP** and **DOWN** to adjust the running speed of the program from **SP.01** (slow) to **SP.20** (fast). Confirm with the **ENTER** button.

Sound control

Via the integrated microphone the unit can perfectly reproduce the show programs to the rhythm of the music (sufficient bass provided).

- 1 Press the **MENU** button so many times until **SOUND** is indicated in the display. Confirm with the **ENTER** button. Use the buttons **UP** and **DOWN** to select the desired show program. Confirm with the **ENTER** button.

Interconnecting several devices (master/slave operation)

Several devices may be interconnected (max. 32). Then all slave units can be synchronized and controlled with the master unit without the need for a DMX controller. The devices must be set to the corresponding operating modes.

Configure all slave units before connecting the master unit: Set the desired master mode **SOUND** or **AUTO** - for the master device, as described above. Set the **DMX** mode for all slave devices.

- 1 Connect the DMX output of the master unit to the DMX input of the first slave unit. Then connect the DMX output of the first slave unit to the DMX input of the second slave unit, etc. until all units have been connected in a chain. Make sure the master unit is the first in the chain. Do not connect a DMX controller to the DMX input of the master unit.
- 2 Set the master unit to the desired operating mode. The interconnected devices will now operate synchronically.

DMX operation

Setting the number of DMX channels and the DMX starting address

For operation with a controller with DMX512 protocol, the device is equipped with 24 control channels. However, it can also be switched to a mode with 6 channels if different functions are required. To be able to operate the device with a DMX controller, the DMX starting address must be set for the first DMX channel. The starting address depends upon which DMX controller is being used. Please refer to the controller's documentation.

- 1 Press the **MENU** button so many times until **PERS** is indicated in the display. Confirm with the **ENTER** button.
- 2 The display indicates **6 CH** (6 DMX channels) or **24 CH** (24 DMX channels). Use the buttons **UP** and **DOWN** to select the desired number of DMX channels. Confirm with the **ENTER** button.
- 3 Press the **MENU** button so many times until **dMX** is indicated in the display. Confirm with the **ENTER** button.
- 4 Now the display indicates the menu item for the DMX start address **d.*****. Use the buttons **UP** and **DOWN** to set the address. Confirm with the **ENTER** button.
- 5 A dot will blink when DMX signals are being received. If no control signals are available, the dot will not blink.

Note: Please make sure that you do not have any overlapping channels in order to control each device correctly and independently from any other fixture on the DMX chain. If several devices are addressed similarly, they will work synchronically.

Functions in DMX mode

Mode/ Channel		DMX value			Feature
6 CH	24 CH				
1	1	Dimmer intensity			
		0	255	F	Gradual adjustment of the dimmer intensity from 0 to 100 %
2	2	Strobe			
		0	9	S	No function
		10	255	F	Strobe-effect with increasing speed

Auto programs

0	9	S	No function
10	19	S	Sound controlled program MOD1
20	29	S	Sound controlled program MOD2
30	33	S	Auto program 1
34	37	S	Auto program red
38	41	S	Auto program green
42	45	S	Auto program blue
46	49	S	Auto program yellow
50	53	S	Auto program cyan
54	57	S	Auto program pink
58	61	S	Auto program white
62	65	S	Changing color rainbow
66	69	S	Red 1
70	73	S	Red 2
74	77	S	Red 3
78	81	S	Green 1
82	85	S	Green 2
86	89	S	Green 3
90	93	S	Blue 1
94	97	S	Blue 2
98	101	S	Blue 3
102	105	S	Yellow 1
106	109	S	Yellow 2
110	113	S	Yellow 3
114	117	S	Cyan 1
118	121	S	Cyan 2
122	125	S	Cyan 3
126	129	S	Pink 1
130	133	S	Pink 2
134	137	S	Pink 3
138	141	S	White 1
142	145	S	White 2
146	149	S	White 3
150	153	S	Red strobe1
154	157	S	Red strobe2
158	161	S	Red strobe3
162	165	S	Green strobe 1
166	169	S	Green strobe 2
170	173	S	Green strobe 3
174	177	S	Blue strobe 1
178	181	S	Blue strobe 2
182	185	S	Blue strobe 3
186	189	S	Yellow strobe 1
190	193	S	Yellow strobe 2
194	197	S	Yellow strobe 3
198	201	S	Cyan strobe 1
202	205	S	Cyan strobe 2
206	209	S	Cyan strobe 3
210	213	S	Pink strobe 1
214	217	S	Pink strobe 2
218	221	S	Pink strobe 3
222	225	S	White strobe 1
226	229	S	White strobe 2

3

3

English

	230	233	S	White strobe 3
	234	255	S	Auto program 2
4	Red			
	0	255	F	Red 0 - 100 % increasing
5	Green			
	0	255	F	Green 0 - 100 % increasing
6	Blue			
	0	255	F	Blue 0 - 100 % increasing
4	Red 0			
	0	255	F	Red 0 - 100 % increasing
5	Green 0			
	0	255	F	Green 0 - 100 % increasing
6	Blue 0			
	0	255	F	Blue 0 - 100 % increasing
7	Red 1			
	0	255	F	Red 0 - 100 % increasing
8	Green 1			
	0	255	F	Green 0 - 100 % increasing
9	Blue 1			
	0	255	F	Blue 0 - 100 % increasing
10	Red 2			
	0	255	F	Red 0 - 100 % increasing
11	Green 2			
	0	255	F	Green 0 - 100 % increasing
12	Blue 2			
	0	255	F	Blue 0 - 100 % increasing
13	Red 3			
	0	255	F	Red 0 - 100 % increasing
14	Green 3			
	0	255	F	Green 0 - 100 % increasing
15	Blue 3			
	0	255	F	Blue 0 - 100 % increasing
16	Red 4			
	0	255	F	Red 0 - 100 % increasing
17	Green 4			
	0	255	F	Green 0 - 100 % increasing
18	Blue 4			
	0	255	F	Blue 0 - 100 % increasing
19	Red 5			
	0	255	F	Red 0 - 100 % increasing
20	Green 5			
	0	255	F	Green 0 - 100 % increasing
21	Blue 5			
	0	255	F	Blue 0 - 100 % increasing
22	Red 6			
	0	255	F	Red 0 - 100 % increasing
23	Green 6			
	0	255	F	Green 0 - 100 % increasing
24	Blue 6			
	0	255	F	Blue 0 - 100 % increasing